

Linear Straight Graphic Panel Kit B

Linear allows you to deliver a show stopping custom built exhibition stand, attractive and durable aluminium finish ideal for large impressive display and retail environments



features & benefits

- Portable and easy to assemble
- Anodised aluminium construction
- 75mm round modular post system as standard
- Available in 5 different graphic sizes 1000mm(h) x 2000mm(w), 2000mm(h) x 500mm(w), 1000mm(w), 2000mm(w) and 3000mm(w)
- Steel oval bases supplied as standard



Recommended accessories:



Linear standard shelf - **LN130**

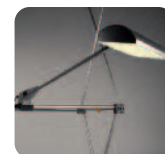

LED Flood light **PS1050**
Requires **US-LINEAR** light bracket



Acrylic stacks **LN602-LCA**

hardware specifications

Overall assembled size (mm)

LK021-A -	1000(h) x 2550(w) x 400(d)
LK021-B -	2000(h) x 1050(w) x 400(d)
LK021-C -	2000(h) x 1550(w) x 400(d)
LK021-D -	2000(h) x 2550(w) x 400(d)
LK021-E -	2000(h) x 3550(w) x 400(d)

We are continually improving and modifying our product range and reserve the right to vary the specifications without prior notice. All dimensions and weights quoted are approximate and we accept no responsibility for variance. E&OE.

Assembly Instructions

Linear Straight Graphic Panel Kit B includes:



Please note that the above kit is based on a LK020-D

Important: Once frame is complete apply steel tape around the frame and PVC extrusion

To attach the graphic simply apply mag tape to the graphic and align the graphic with the frame

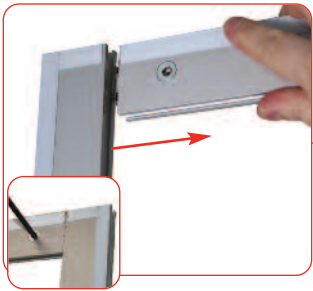

Attach horizontal beams to the vertical frame sides. Tighten locks using a 5mm allen key. If using rigid infill graphics, slide these in to position before tightening beams.



Attach assembled frame to vertical posts using 4 x 150mm beams. Tighten locks using a 5mm Allen key.

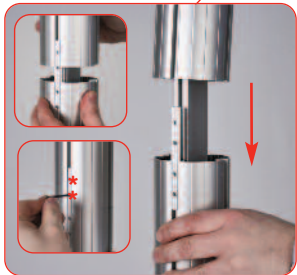

Align and slide female post over male post, tighten both grub screws using a 2mm allen key. Repeat step for 2nd post.



Attach base to male post using M10 bolt and allen key. Ensure clear washer is between base & post. Repeat step for 2nd post.